



SIDE HINGED GARAGE DOORS





Traditional design doors are a very popular option when refurbishing a garage. Many garages are now under conversion to be used as utility rooms, extra storage, gyms, or hobby spaces.



'Pebble Grey' colour, vertical layout, rib woodgrain panels, obscure front glass, 'cross' glazing.



Vertical layout, mid-rib woodgrain panels, obscure front glass, 'BS' glazing.



Vertical layout, rib woodgrain panels, obscure front glass, 'cross' glazing.



'Sky blue' colour, vertical layout, rib woodgrain panels, obscure front glass, 'cross' glazing.

TRADITIONAL DESIGN

A classic design door.
Replace the door but not the style!
Any RAL or BS colour including wood image colours.

Double glazed panel with clear, matt, obscure or tinted glass. An internal cross décor can be added.



Glazing panels in contrasting 'Flame red' colour.



'Anthracite grey' colour, horizontal layout, slick smooth panels, matt continuous glazing.



'Golden Oak' finish, horizontal layout, 'BS' tinted glazing, 60/40 split.

MODERN DESIGN

Modest luxury combined with functionality. Vertical layout along with glazed panels and pull handles to create an elegant appearance. 'Modern' is one of our main designs.



'Modern' design with stainless steel lever handle and decorative decals to match entrance door design.

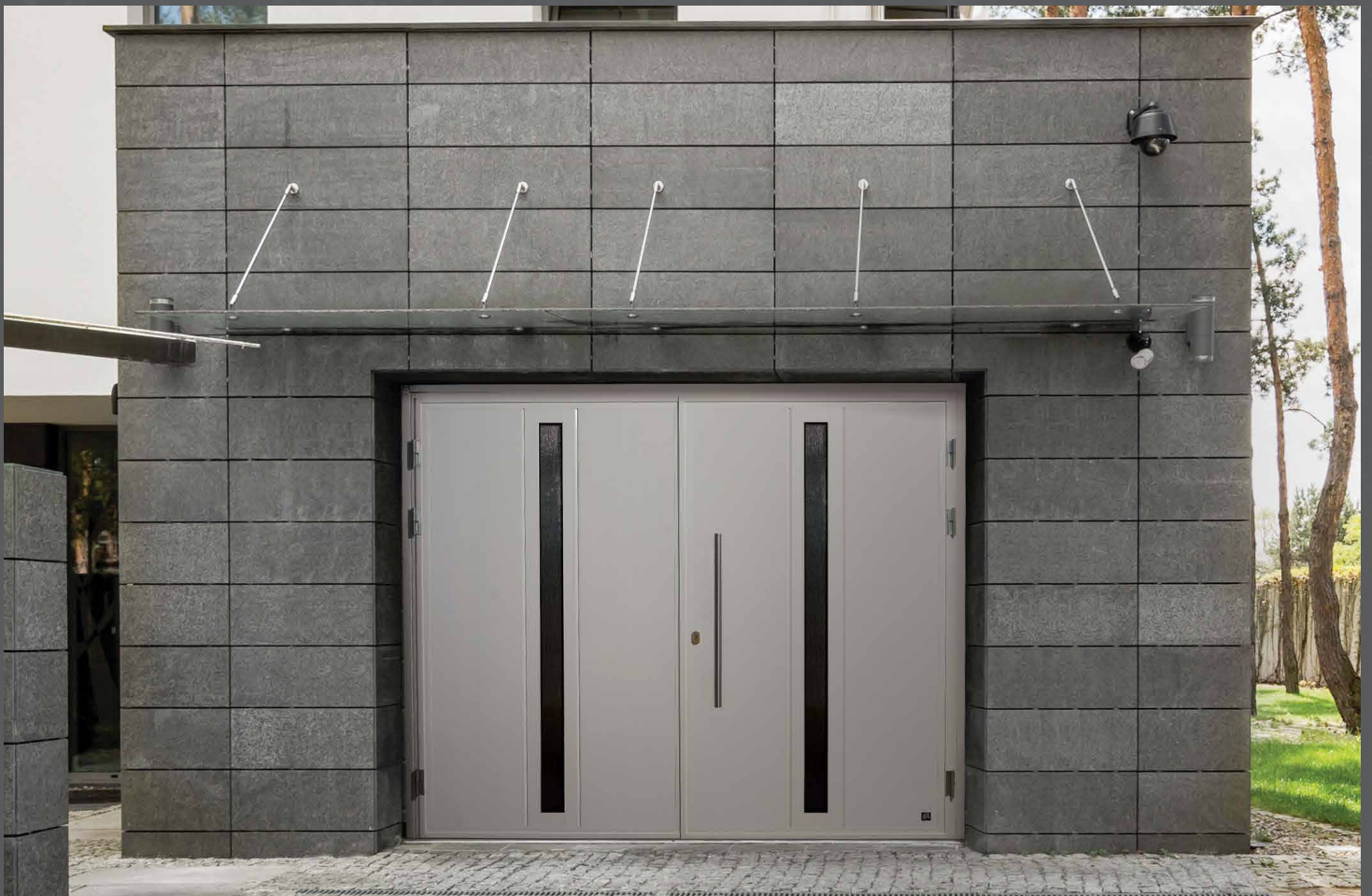

Smooth 'stainless steel' image panels in combination with 1 metre long stainless steel handle perfectly matches modern setting.



'Anthracite Grey' smooth surface panels, 1.2 metre long pull-handle and matt glazing.



White smooth surface door and black powder-coated glazing frames with pull handles create an image of classic elegance.

DIAMOND DESIGN

Diamond design door will make your home 'sweet home'. Two design panels combined in chevron layout along with 8 square 15x15 cm stainless steel windows create a cosy and welcoming appearance.



'Diamond' design door in asymmetric split.



Door leaves in 'Chartwell Green' and windows in black finish.



'Diamond' design in 'Anthracite grey' finish.

RETRO DESIGN

Retro design doors if you want to comply with conservation area regulations or just resemble the 'good old' door. With the help of different design elements, we can get the desired look.



Hinges and pull-handles made to look as wrought iron create a hand-made old fashion barn door.

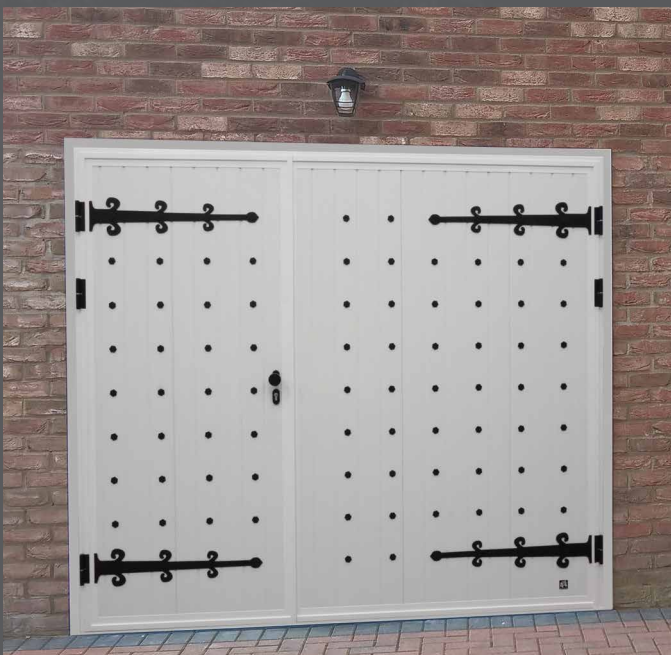

'Castle' design. Wrought iron accessories turns modern door into armoured castle door.



Composite fiber-cement planks allow to create image resembling carriage-house or stables door image.

STAINLESS STEEL WINDOWS, PULL-HANDLES & DECALS

Stainless steel decals, handles and windows can create vibrant look of your door. Using one or a combination of elements you can create elegant kerb appeal. All elements can be powder coated to a colour of your choice to create subtle or dramatic design contrasts.



Horizontal narrow stainless metal decals highlights the elegance of the door design.



Custom designed stainless metal motif.



'Byron' design - combination of square windows and metal decals.



Entrance and garage doors made in matching design. 500mm pull-handle, 'Mid-rib' design.



Smooth surface 'Anthracite Grey' finish perfectly contrasts with stainless steel kick plate.



800mm length round pull-handles and window frames powder-coated to match 'Light Oak' door colour.

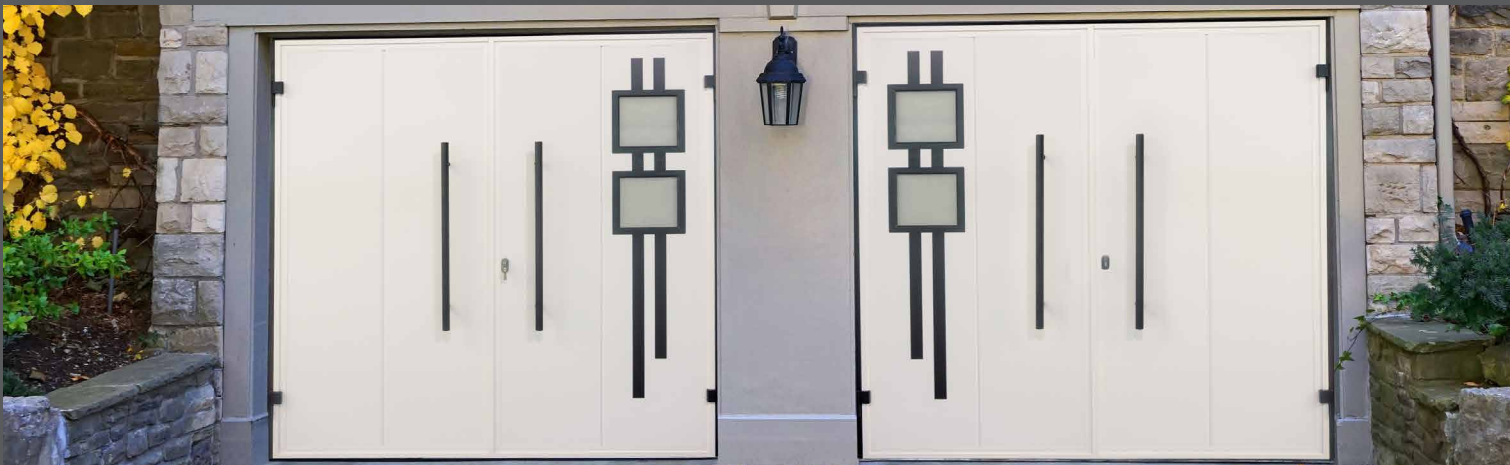

'Byron' design doors with 1 metre long pull handles. All stainless steel accessories powder coated in black.

COLOURS

Go for your favorite colour. Do not limit yourself with RAL colour-chart, use British Standard, NCS charts as well. If necessary 'Heritage colours' are ready on our palette.



The bright yellow will change your mood whatever how upset you are. The doors feature rectangular pull-handles and oblong stainless steel windows.



'Traffic Red' finish with 'Sails' design stainless metal decals

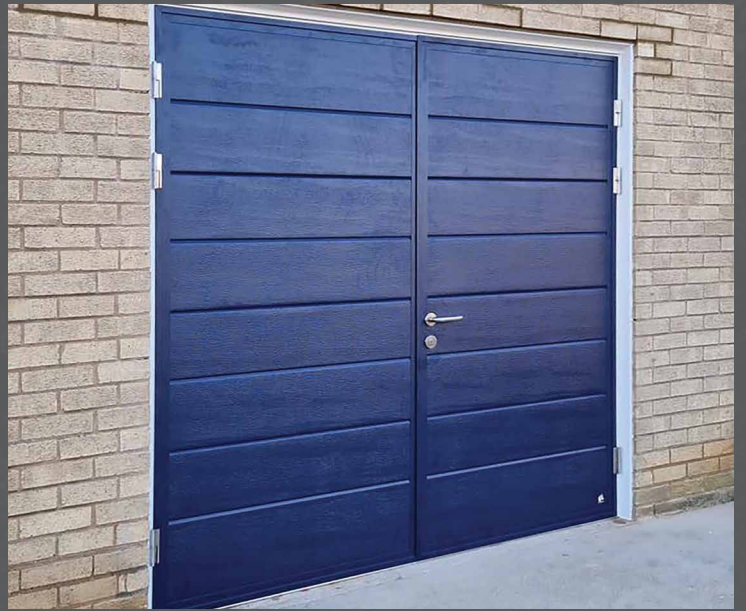

Humble door in 'Sapphire Blue' finish with stainless steel lever handle.



'Moss Green' matches with a masonry colour.



'Chartwell Green' bi-fold door.

HANDLES

STANDARD HANDLES



STAINLESS STEEL PULL HANDLES



Round shape

Rectangular shape

LEVER HANDLES



HLS 02



HLS 03



HLS 04



HLS 05



HLS 06



HLS 12

Available lengths:

- 500 mm
- 800 mm
- 1000 mm
- 1200 mm
- 1800 mm



Outside



Inside

STAINLESS STEEL

Knob - outside

Lever handle - inside

Not compatible with 3 point lock.



LOCK ASSA MODULAR 565

Security option - high security lock. Chrome plated handle and lock plate cover.

Not compatible with 3 point lock.



FIXED KNOB

Fixed knob handle

Possible door colour and handle colour combinations:

- white handle for white doors,
- black handle for colour and wood image doors,
- aluminium handle - upon request.

Improved C-shape soft rubber sealing all around the perimeter and between the leaves

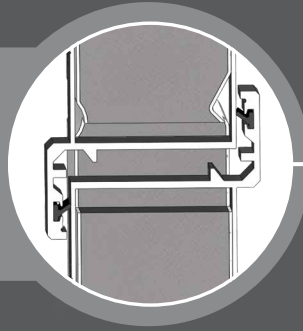

Frame mouldings. This option allows door to be fitted flush with the front wall hiding any small gaps or crumbled brickwork. Same colour as frame. On left side frame with moulding on right - without moulding.



4 hinge bolts.
Higher burglar resistance.



Garage door can be with integrated pet flap.
If you have garage door facing the street - integrated letter box can be an option.



First door leaf can be left-hand or right-hand swing. The door split can be 50/50; 30/70 or any other reasonable proportion. Max leaf width 1.5 metre.

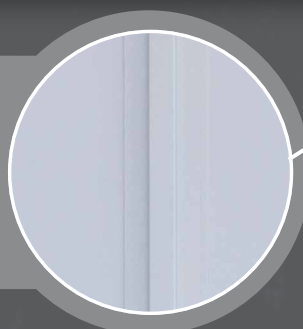

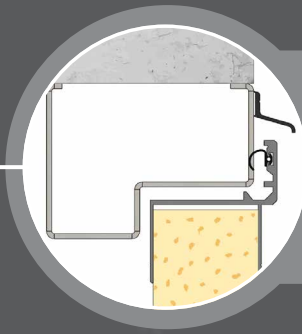

Canopy profile diverts rain water from penetrating between frame and leaf.

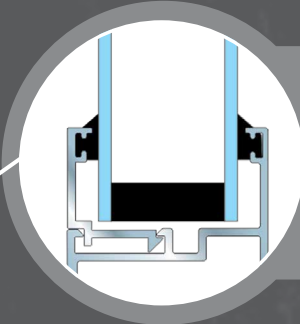

Scratch proof energy efficient double glazing. Acrylic glass.



As a standard one-point lock. For higher security 3-point or Assa-Modular locks can be an option. All locks come with 5 keys.

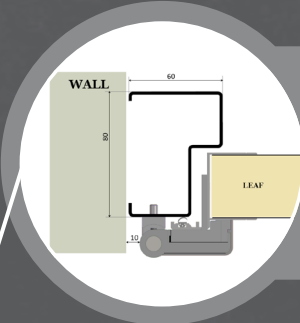

Rebated, zinc coated, robust and maintenance free steel frame. Painted same colour as the door or different if specified.



Adjustable aluminium alloy hinges with bearings. Standard colours: white, black, silver.

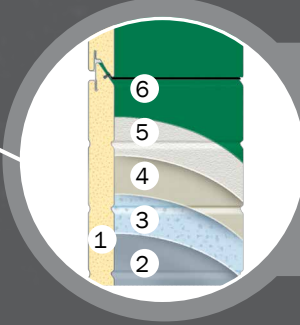

Energy efficient insulated door panels. Double steel skin filled with freon free PU foam: 1- 40mm thick foam; 2- steel; 3- zinc; 4- primer; 5- finish coating; 6- colour.

Clear scratch-proof, matt, or obscure glazing. An internal Cross can be added. Frames can be colour matched.



Key Cylinder with Thumb-Turn. Convenience option - fast door locking from inside without key.

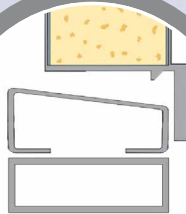
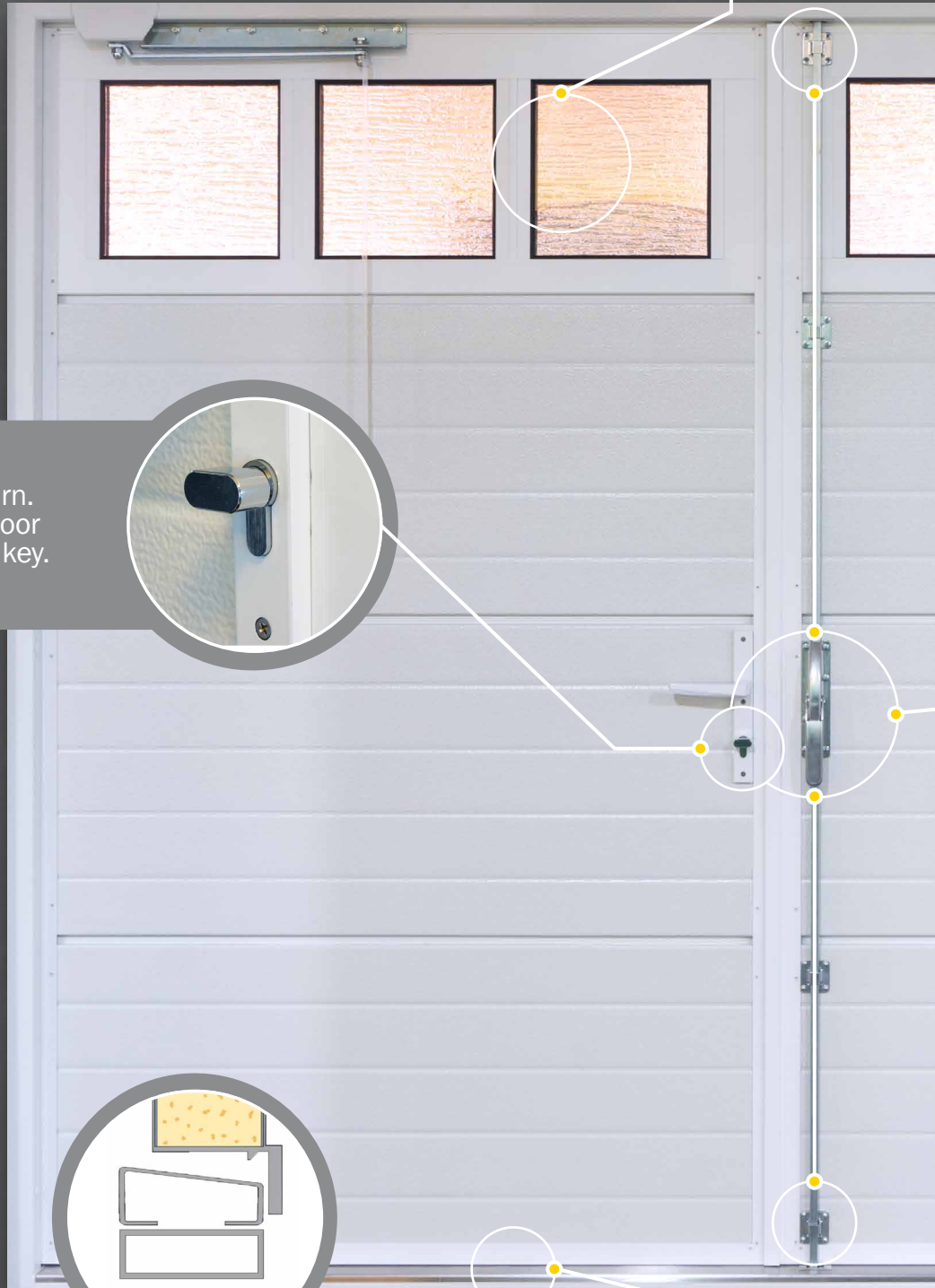

Raised

Standard S5 sloping threshold made of zinc coated steel profile. Optional - stainless steel plated. S1 & S4 thresholds available as well. 30 mm raised threshold available.

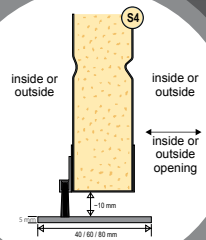
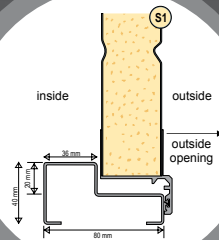
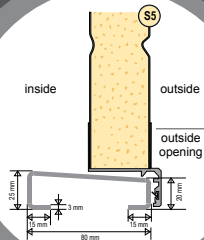



Heavy duty doors stays. Door stays keep door leaf in open position. Easy to lock and release. Safe to use even on a windy days.



Adjustable leaf opening angle 90 - 140 degrees.



Optional espagnolette lock to keep second leaf in a closed position. Designed to make opening the second door leaf effortless. Standard option - integrated two shut-bolts on second leaf.



Stainless steel cover for S5 threshold. Gives more beauty to side hinged door and protects threshold paint from wearing off.



www.ryterna.com
www.ryternaentry.com